

7' Wide V-Track



POPULAR OPTIONS

Light Package

12V Quartz Loading Light

Aluminum Wheels

Heater

Smooth White Aluminum on White Vinyl Walls

Overhead Cabinets



THE BEST NAME BEHIND YOU FOR THE LONG HAUL

7' Wide V-Track Specifications

Model		FVT7x21WT2	FVT7x23WT2	FVT7x25WT2	FVT7x27WT2
Overall	Length	23' 8"	25' 8"	27' 8"	29' 8"
	Width	102"	102"	102"	102"
	Height	96"	96"	96"	96"
Interior	Length	15' 9"	17' 9"	19' 9"	21' 9"
	V-Nose	4' 8"	4' 8"	4' 8"	4' 8"
	Width	80 1/2"	80 1/2"	80 1/2"	80 1/2"
	Height	72"	72"	72"	72"
Platform Height		22"	22"	22"	22"
Torflex EZ Lube Axles					
	Quantity	tandem	tandem	tandem	tandem
	Total Capacity	7000	7000	7000	7000
	Type	drop	drop	drop	drop
Brakes		4 Wheel Electric	4 Wheel Electric	4 Wheel Electric	4 Wheel Electric
Tire Size		ST205/R15 15"	ST205/R15 15"	ST205/R15 15"	ST205/R15 15"
Tire Load Range		C	C	C	C
Wheel Bolt Pattern		5 - 4 1/2	5 - 4 1/2	5 - 4 1/2	5 - 4 1/2
Hitch Ball Size		2 5/16"	2 5/16"	2 5/16"	2 5/16"
Hitch Height to Top of Ball		21"	21"	21"	21"
Hitch Weight		320	340	360	380
Curb Weight		3340	3460	3580	3700
GVWR		7000	7000	7000	7000
Payload Capacity (Avg.)		3660	3540	3420	3300
Rear Doors	Standard	Ramp*	Ramp*	Ramp*	Ramp*
Front Ramp		60"	60"	60"	60"
Camlocks		yes	yes	yes	yes
Rear Opening	Width	74 3/4"	74 3/4"	74 3/4"	74 3/4"
	Height	67 1/2"	67 1/2"	67 1/2"	67 1/2"
12V Female/Male Connec.		7 way	7 way	7 way	7 way
Prefinished Aluminum Skin		.030	.030	.030	.030
Interior Walls	Top	Luan	Luan	Luan	Luan
	Bottom	3/8" ply	3/8" ply	3/8" ply	3/8" ply
Floor		Wolmanized	Wolmanized	Wolmanized	Wolmanized
Front Jack		yes	yes	yes	yes
DOT Lighting/Dbl Bulb		yes	yes	yes	yes
Safety Chains and Hooks		yes	yes	yes	yes
White Spoke Wheels		yes	yes	yes	yes
Aluminum Fenders		yes	yes	yes	yes
Breakaway Kit		yes	yes	yes	yes
D-Ring Tiedowns		yes	yes	yes	yes
12V Dome Light & Switch		yes	yes	yes	yes
Vinyl Ceiling		std.	std.	std.	std.
Floor Crossmembers = 24" OC		Wall Studs = 16" OC		Roof Bows = 24" OC	



Red



Indigo Blue



Black



Charcoal



Brandywine



White



Metallic Silver

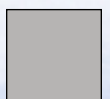

Dove Gray



Forest Green

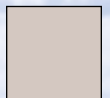

Champagne Beige

* Rear Ramp Door with Spring Assist

**Trailer Weights Will Vary When Optional Equipment is Added

Rev 402

Haulmark's Commitment to Quality

For over 20 years Haulmark has constructed the best-built trailers in America. We recognize and value the importance of strength, durability and quality and strive to give our customers nothing less.

Haulmark designs and construction reflect a tradition of total commitment to quality. Come see why Haulmark is "the best name behind you for the long haul."

800-348-7530 • www.haulmark.com

Indiana Pennsylvania Utah Georgia Arizona

DEALER IMPRINT

All of the information printed was based on the latest product information available at the time of publication. Haulmark reserves the right to make changes at any time in prices, colors, materials, equipment, specifications and models and to discontinue models without notice or obligation. Photos may show optional equipment which is not a standard item on a particular unit. Please see your dealer for complete details about standard and optional equipment.



Manufacturer of Steel Frame Trailers of Quality

© Copyright 1998 Haulmark Industries, Inc.